

Teguflex FFL BL 250/300 DN 500-DN 2600

Flange qualities

Standard design RST 37-2, with rust resisting primer coating.

Other materials and surface treatments available by agreement.

Flange measurements

DN 500-DN 2600 DIN 2501 PN 6/10

(see Flange dimension table for details)

Other flanges standards available. Please ask.

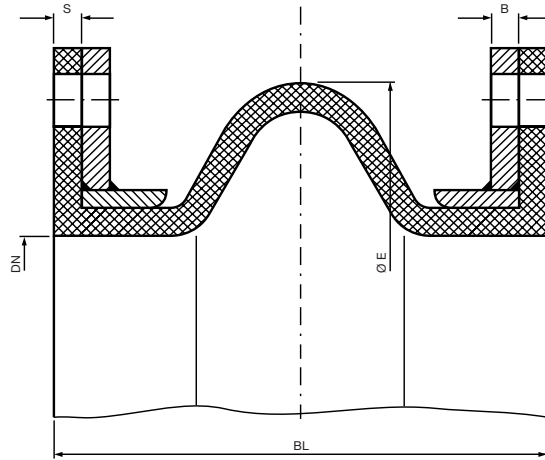

Dimensions and movements

DN mm	BL mm	Eff.cross-sectional area Q(cm ²)	(E) mm	(S) mm	(B) mm	Permissible movements				Max. vacuum		Weight
						Com- pression mm	Elon- gation mm	Lateral mm	An- gular	W/o support ring bar	With support ring bar	Incl. flange kg
500	250	1860	620	12	12	40	30	30	6.5°	0.2	1.0	45
600	250	2790	725	15	12	40	30	30	5.4°	0.2	1.0	57
700	250	4300	840	15	15	40	30	30	4.8°	0.2	1.0	84
800	250	4950	950	15	15	40	30	30	4.3°	0.2	1.0	100
900	250	6610	1050	15	15	40	30	30	3.7°	0.2	1.0	113
1000	250	8700	1160	15	15	40	30	30	3.3°	0.2	1.0	133
1100	300	10900	1270	15	15	40	30	30	3.1°	0.2	1.0	150
1200	300	12900	1380	20	20	40	30	30	2.8°	0.2	1.0	180
1400	300	17200	1590	20	20	40	30	30	2.4°	0.2	1.0	230
1500	300	19600	1705	20	20	40	30	30	2.3°	0.2	1.0	250
1600	300	22200	1820	20	20	40	30	30	2.1°	0.2	1.0	285
1800	300	27800	2020	20	20	40	30	30	1.9°	0.2	1.0	315
2000	300	34000	2230	20	20	40	30	30	1.7°	0.2	1.0	360
2200	300	40800	2440	25	25	40	30	30	1.5°	0.2	1.0	445
2400	300	48000	2650	25	25	40	30	30	1.4°	0.2	1.0	520
2600	300	55200	2860	25	25	40	30	30	1.2°	0.2	1.0	550

Note: Maximum values do not apply simultaneously.
Other building lengths and/or dimensions available. Please ask.

Optional equipment

Vacuum rings are available.



Trelleborg Izarra, S.A.U.

C/ San Vicente, 23 - E01440 Izarra (Alava) - Spain - Tel.: +34 945 437 000 - Fax: +34 945 437 007
E-mail: izarra@trelleborg.com - E-mail: expansionjoints@trelleborg.com - www.trelleborg.com/expansionjoints

Distributor: